

SHIELD™

SHIELD

FIRE FIGHTING EQUIPMENTS

INDEX

Fire Extinguishers

CO ₂ Portable Fire Extinguishers	300
CO ₂ Mobile Fire Extinguishers	301
ABC Dry Powder Portable Fire Extinguishers	302
ABC Dry Powder Mobile Fire Extinguishers	303
Water Portable Fire Extinguishers	304
Foam Portable Fire Extinguishers	305
Foam Mobile Fire Extinguishers	306
Wet Chemical Fire Extinguishers	307

Fire Hoses & Accessories

Semi-Rigid Reel Hose	308
Fire Hose Reel With Semi-Rigid Hose	309
Fire Hose	312
Delivery Hose Coupling	313
Handheld Branch Pipe	314
Standard Branch Pipe	315

Landing Valves

Oblique Valve, Flanged Inlet	316
Oblique Valve, Male Threaded Inlet	317
Pressure Reducing Valve, Flanged Inlet	318

Breeching Inlets

4" X 2 Way Breeching Inlet	319
6" X 4 Way Breeching Inlet	320

Fire Hydrants

Dry Pillar Fire Hydrants	321
Under Ground Hydrant	323
Stand Pipe Outlet	325

CO₂ PORTABLE FIRE EXTINGUISHERS



FEATURES

- Carbon dioxide is a gaseous agent, colorless, odorless / non-toxic and provides rapid knock down of industrial fire. It is capable of fighting Class B fire effectively.
- Kitemark Certified to BS EN3.
- Cylinders compliant to council directive 97/23/EC (PED) and Statutory instrument 1999 No. 2001 is certified by BSI (0086).
- Seamless steel body.
- High quality polyester paint.
- Controlled discharge.
- Brass head valve with simple squeeze operations provided with pressure relieve disc.
- Rechargeable & easy to service.
- Non-conductive agent for electrical use without risk to operator.
- CO₂ gas disappears quickly leaving no residue.
- Swivel horn with no freeze burn, with greater directional control of CO₂ discharge through horn rotation feature.
- 2Kg is available with the 55B Fire rating as efficient as 5Kg unit.



IDEAL USE:

Chemical manufacturing plant, oil rigs, rail yards, warehouses, construction sites, parking garages, airport, boat and docks, and large laboratories.

Model Number	SDC2	SDCS2	SDCZ2	SDC2A	SDC5	SDC5A
Extinguisher Capacity	2 Kg	2 Kg	2 Kg	2 Kg	5 Kg	5 Kg
Propellant	Self Propelling					
Fire Rating	34B	34B	55B	55B	55B	55B
Working Pressure	55-60 Bar @ 25°C					
Maximum Operating Pressure	169 Bar @ 60°C					
Test Pressure	250 Bar					
Total Weight	8.2 Kg	8.3 Kg	8.3 Kg	4.9 Kg	17.5 Kg	12.1 Kg
Range of Discharge	4-5m	4-5m	4-5m	4-5m	5-6m	5-6m
Duration of Discharge	8-9 sec	8-9 sec	10-12 sec	10-12 sec	10-12 sec	10-12 sec
Hose Length	N/A	N/A	N/A	N/A	750mm	750mm
Operating Temperature	-20°C to +60°C					
Cylinder Material	Carbon Steel	Carbon Steel	Carbon Steel	Aluminium	Carbon Steel	Aluminium
Height x Diameter (mm)	610 x 101.6	610 x 101.6	610 x 101.6	572 x 111	760 x 139.7	698 x 152

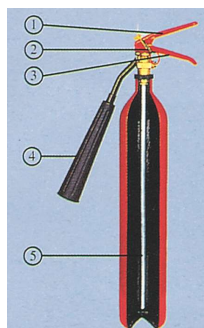

1. Valve / Extn. Lever
2. Safety Pin with Chain
3. Valve Handle
4. Discharge Horn
5. Syphon Tube

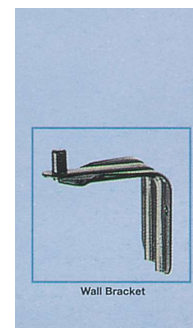

CO₂ MOBILE FIRE EXTINGUISHERS

PRODUCT DESCRIPTION

SHIELD Mobile CO₂ fire extinguishers are characterized by their high performance and simple method of operation. They are suitable for fires involving flammable liquids, gases and electrical equipment. Effective for Class B, C & E. Suitable for Class B fire risks.

FEATURES

- The Fire Extinguishers are designed to comply with the specifications and requirements of BSEN 1866-1.
- Kitemark approved.
- High-grade brass head valve ensures reliability and optimizes efficiency.
- Discharge outlet is controlled by High Pressure Ball Valve.
- High gloss polyester powder painted UV stabilized after shot blasting ensures corrosion resistance under extreme conditions.
- Safety valve is fitted in each extinguisher for maximum safety.
- Discharge nozzle designed to produce a jet of extinguishing gas.



Model Number	SDTC 10	SDTC 30
Extinguisher Capacity	10 Kg	30 Kg
Fire Rating	70B	113B
Working Pressure	55 - 60 Bar @ 25°C	55 - 60 Bar @ 25°C
Maximum Operating Pressure	169 Bar @ 60°C	169 Bar @ 60°C
Test Pressure	250 Bar	250 Bar
Total Height & Width	1,435 x 440 mm	1,095 x 675 mm
Total Weight	52 Kg	125 Kg
Range of Discharge	6-8 m	6-8 m
Duration of Discharge	19 - 21 sec	42 - 45 sec
Operating Temperature	-20°C to +60°C	-20°C to +60°C
Propellant	Self Propellant	Self Propellant
Hose Size & Length	Bore 3/8" x 5m	Bore 3/8" x 5m
Cylinder Material	Carbon Steel	Carbon Manganese Steel

ABC DRY POWDER PORTABLE FIRE EXTINGUISHERS

FEATURES

- Mono-ammonium phosphate based dry chemical agent.
- Capable of fighting Class A, B, C and E fires.
- Kitemark certified to BS EN3.
- Cylinders compliance to council directive 97/23/EC (PED) and Statutory instrument 1999 No.2001 is certified by BSI (0086).
- High quality polyester paint.
- Controlled discharge.
- Brass nickel plated head valve with simple squeeze operation.
- Unique gauge testing system.
- Unique colour coded handle and base (optional).
- Rechargeable and easy to service.
- Choice of capacity from 1 to 12 Kg.

IDEAL USE

Houses, office, buildings, warehouses, farms, wood working area etc.

*NOTE

Not recommended for use on expensive and delicate equipment like computers, etc.



Model Number	SDP1	SDP2	SDP4	SDP6	SDP9	SDP12
Extinguisher Capacity	1 Kg	2 Kg	4 Kg	6 Kg	9 Kg	12 Kg
Propellant	95% Nitrogen + 5% Helium					
Fire Rating	8A 34B	13A 70B	21A 113B	34A 183B	43A 233B	55A 233B
Working Pressure	14 Bar	14 Bar	15 Bar	15 Bar	15 Bar	15 Bar
Maximum Operating Pressure	18.5 Bar @ 60°C					
Test Pressure	30 Bar					
Total Weight	2.0 Kg	3.7 Kg	7.5 Kg	10 Kg	14 Kg	17.8 Kg
Range of Discharge	4-5m	5-7m	7-8m	6-8m	6-8m	6-8m
Duration of Discharge	7-9 sec	10-12 sec	13-15 sec	18-20 sec	22-24 sec	28-30 sec
Hose Length with Nozzle	N/A	N/A	457mm	534mm	534mm	617mm
Operating Temperature	-20°C to +60°C					
Cylinder Material	CRCA Steel					
Height x Diameter (mm)	365 x 75	385 x 110	408 x 150	520 x 150	515 x 185	620 x 185

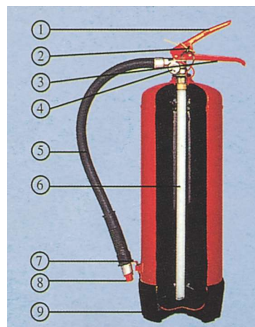

1. Valve / Extn. Lever
2. Safety Pin with Chain
3. Valve Handle
4. Pressure Gauge
5. Discharge Hose
6. Syphon Tube
7. Hose Holder
8. Discharge Nozzle
9. PVC Base



ABC DRY POWDER MOBILE FIRE EXTINGUISHER

PRODUCT DESCRIPTION

SHIELD Mobile stored pressure ABC Dry powder extinguishers are characterized by their high performance and simple method of operation. The ABC Dry powder Mobile type extinguisher contains high performance powder and thus has achieved highest fire rating. They are suitable for multipurpose application of fires involving free burning materials, flammable liquids, flammable gases and electrical equipment.

Effective for Class A, B, C & Electrical fires.

FEATURES

- The fire extinguishers are designed to comply all the specification requirements of BS EN 1866-1.
- Kitemark approved for different capacity extinguishers.
- Highest fire rating due to high performance ABC powder.
- Ready for instant use and simple to operate.
- Fully controlled and easy operation by rust free brass valve.
- Cart and cylinder are made of rugged steel and welded to meet extreme use conditions.
- Easily transportable & Field rechargeable.
- Highly visible pressure-indicating gauge.
- Externally coated by Electrostatic powder painting after shot blasting ensures maximum corrosion resistance.
- Brass nickel plated head valve with simple lever operation.



Model Number	SDTP25	SDTP50	SDTP100
Extinguisher capacity	25 Kg	50 Kg	100 Kg
Fire Rating	IIB	IVB	IVB
Working Pressure	18 Bar	18 Bar	18 Bar
Maximum Working Pressure	22 Bar	22 Bar	22 Bar
Test Pressure	32 Bar	32 Bar	32 Bar
Total Height & Width	1025 x 500 mm	1065 x 550 mm	1105 x 650 mm
Total Weight	Approx. 63 Kg	Approx. 100 Kg	Approx. 172 Kg
Range of Discharge	7-9m	7-9m	8-9m
Duration of Discharge	25-30 Sec	47-55 Sec	85-90 Sec
Operating Temperature	-20°C to +60°C	-20°C to +60°C	-20°C to +60°C
Propellant	Nitrogen	Nitrogen	Nitrogen
Hose size & Length	16mm x 5 mtr	16mm x 5 mtr	16mm x 7 Mtr
Cylinder Material	Carbon Steel Plate		

WATER PORTABLE FIRE EXTINGUISHERS

PRODUCT DESCRIPTION

SHIELD stored pressure water extinguishers are characterised by their high performance, and simple method of operation ideal for tackling freely burning materials such as paper, cloth, wood and furniture. These are good general purpose fire extinguishers and widely used for their cost effectiveness.

FEATURES

- Water, a liquid agent only recommended for fighting Class A Fire.
- Kitemark certified to BS EN3.
- Cylinders compliance to council directive 97/23/EC (PED) and Statutory instrument 1999 No.2001 is certified by BSI (0086).
- High quality external polyester paint.
- Thermoplastic internal coating to prevent corrosion.
- Spray nozzle to provide high fire rating.
- Controlled discharge.
- Brass nickel chrome plated head valve with simple squeeze operation.
- Unique gauge testing system.
- Unique colour code handle and base (Optional).
- Rechargeable and easy to service.



IDEAL USE

Schools, Theaters, Apartments, Offices and Dry Goods Store.

*NOTE

Water based Extinguishers are not suitable for life involving electrical risk.

Model Number	SDW 6	SDWS I6	SDWS 6	SDW 9	SDW S9	SDWSI 9
Extinguisher Capacity	6 Ltr	6 Ltr	6 Ltr	9 Ltr	9 Ltr	9 Ltr
Propellant	95% Nitrogen + 5% Helium					
Fire Rating	13A	13A	13A	21A	13A	13A
Working Pressure	14 Bar					
Maximum Operating Pressure	18.5 Bar @ 60°C					
Test Pressure	30 Bar					
Total Weight	11.5 Kg	11.5 Kg	11.5 Kg	15.5 Kg	15.5 Kg	15.5 Kg
Range of Discharge	6m	6m	6-7m	6-7m	7-8m	7-8m
Duration of Discharge	22-25 sec	22-25 sec	22-28 sec	30-32 sec	32-35 sec	32-35 sec
Hose Length with Nozzle	680mm					
Operating Temperature	+5°C to +60°C					
Cylinder Material	CRCA Steel Sheet					
Height x Diameter (mm)	625x150	625x150	625x150	630x185	630x185	630x185

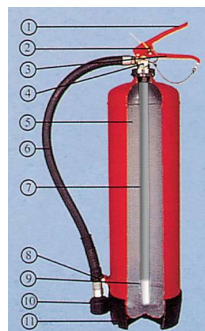

1. Valve/Extn. Lever
2. Safety Pin with Chain
3. Valve Handle
4. Pressure Gauge
5. PVC Internal Coating
6. Discharge Hose
7. Syphon Tube
8. Hose Holder
9. Filter
10. Discharge Nozzle
11. PVC Base

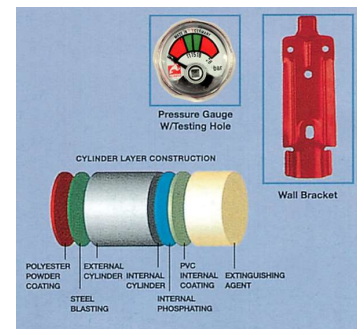

FOAM PORTABLE FIRE EXTINGUISHERS

PRODUCT DESCRIPTION

SHIELD stored pressure foam extinguishers are multipurpose, ideal for fires involving volatile liquids and freely burning materials such as paper, cloth, wood and furniture.

Suitable for Class A and Class B fire risks.

FEATURES

- AFFF (6%) Synthetic Aqueous Film - Forming Foam Agent capable of fighting Class A, B fires.
- Kitemark certified to BS EN3.
- Cylinders compliance to council directive 97/23/EC (PED) and Statutory instrument 1999 No.2001 is certified by BSI (0086).
- High quality external polyester paint.
- Thermoplastic internal coating to prevent corrosion.
- Spray nozzle to provide high fire rating.
- Controlled discharge.
- Brass nickel chrome plated head valve with simple squeeze operation.
- Unique gauge testing system.
- Unique colour code handle and base (Optional).
- Rechargeable and easy to service.



IDEAL USE

Schools, Theaters, Apartments, Offices and Dry Goods Store.

*NOTE

Water based Extinguishers are not suitable for life involving electrical risk.

Model Number	SDF 6	SDFI 6	SDF 9	SDFI 9
Extinguisher Capacity	6 Ltr	6 Ltr	9 Ltr	9 Ltr
Propellant	95% Nitrogen + 5% Helium			
Fire Rating	21A 144B	21A 144B	21A 183B	21A 183B
Working Pressure	14 Bar			
Maximum Operating Pressure	18.5 Bar @ 60°C			
Test Pressure	30 Bar			
Total Weight	11.5 Kg	11.5 Kg	15.5 Kg	15.5 Kg
Range of Discharge	6m	6-7m	7-8m	7-8m
Duration of Discharge	22-25 sec	22-28 sec	32-35 sec	32-35 sec
Hose Length with Nozzle	680 mm	680 mm	680 mm	680 mm
Operating Temperature	+5°C to +60°C			
Cylinder Material	CRCA Steel Sheet			
Height x Diameter (mm)	610x150	610x150	630x185	630x185

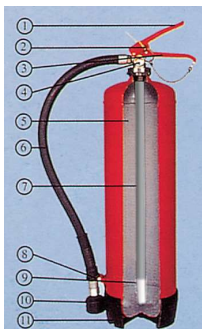

1. Valve/Extn. Lever
2. Safety Pin with Chain
3. Valve Handle
4. Pressure Gauge
5. PVC Internal Coating
6. Discharge Hose
7. Syphon Tube
8. Hose Holder
9. Filter
10. Discharge Nozzle
11. PVC Base

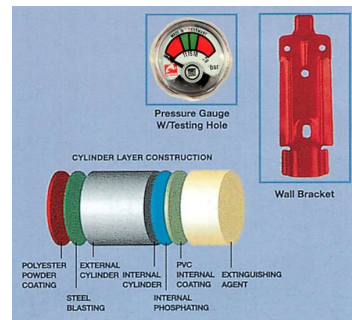

FOAM MOBILE FIRE EXTINGUISHERS



PRODUCT DESCRIPTION

SHIELD Mobile external cartridge operated foam fire extinguishers are characterized by their high performance and simple method operation. The extinguisher contains high performance extinguishing agent 6% AFFF foam and thus has achieved the highest fire rating. SHIELD Mobile Foam extinguishers are most suitable for fires involving flammable liquids and freely burning materials such as paper, cloth and wood.

Effective for Class A & Class B fires.

FEATURES

- The fire extinguishers are designed to comply with all the specification requirements of BS EN 1866-1.
- Kitemark approved for different capacity extinguishers.
- Agent used is AFFF (6%) Synthetic Aqueous film forming foam for effective fire extinguishment.
- Incorporated with high pressure CE approved CO₂ cylinder as propelling agent.
- Ready for instant use and simple to operate.
- Cart and cylinder are made of rugged steel and welded to meet extreme use conditions.
- Easily transportable.
- Externally coated by Electrostatic powder painting after shot blasting ensures maximum corrosion resistance.
- Internally coated by electrostatic block powder using resin for corrosion resistance.
- Large Brass, nickel chrome plated cap for ease during refilling the agent.
- Cylinder assemblies are designed for easy maintenance by mounting it separately on steel frame and thus can be separated by just removing the steel clamps.



Model Number	SDTF C50	SDTF C100	SDTF C135
Extinguisher capacity	50 Ltr	100 Ltr	135 Ltr
Fire Rating	IVB	IVB	IVB
Propellant	CO ₂	CO ₂	CO ₂
Working Pressure	14 Bar	14 Bar	14 Bar
Test Pressure	32 Bar	32 Bar	32 Bar
Maximum Working Pressure	18.5 Bar	18.5 Bar	18.5 Bar
Total Weight	112.5 Kg	189 Kg	232 Kg
Range of Discharge	6-8 Mtr	8-10 Mtr	8-10 Mtr
Duration of Discharge	55-65 Sec	110-120 Sec	160-170 Sec
Hose Length	16mm x 5 Mtr	16mm x 7 Mtr	16mm x 7 Mtr
Operating Temperature	+5°C to +60°C	+5°C to +60°C	+5°C to +60°C
Cylinder Material	Carbon Steel Plate		
Extinguisher Height & Width (mm)	1065 x 550	1100 x 625	1005 x 700

WET CHEMICAL FIRE EXTINGUISHERS



PRODUCT DESCRIPTION

SHIELD stored pressure type wet chemical extinguishers are used for cooking oil or fat fires where the spray can create a flame almost immediately. Extinguishment happens while the wet chemical agent reacts with oil to form a soap like film to seal the surface of the oil and cool it down to prevent re-ignition.

Effective for Class A, B, C & Electrical fires.

FEATURES

- Water, a liquid agent only recommended for fighting Class F & A Fire.
- Kitemark certified to BS EN3.
- Cylinders compliance to council directive 97/23/EC (PED) and Statutory instrument 1999 No.2001 is certified by BSI (0086).
- High quality polyester paint.
- Internally coated by thermoplastic coating powders blend of polyolefin to prevent corrosion.
- Fire mist spray to prevent grease splashing.
- Brass nickel chrome plated head valve with simple squeeze operation.
- Unique gage testing system.
- Unique color code handle and base (optional).



- Rechargeable and easy to service.
- Passed 35K electrical conductivity test.

IDEAL USE:

Commercial kitchens in connection with SHIELD Pre-engineered Hood Systems.

*NOTE

Don't use on electrical fire.

Model Number	SDKE 3	SDKE 6
Extinguisher Capacity	3 Ltr	6 Ltr
Propellant	95% Nitrogen + 5% Helium	
Fire Rating	8A 25F	13A 75F
Working Pressure	10 Bar	10 Bar
Maximum Operating Pressure	11.5 Bar @ 60°C	11.5 Bar @ 60°C
Test Pressure	30 Bar	30 Bar
Total Weight	7.2 Kg	12.5 Kg
Range of Discharge	1m	1m
Duration of Discharge	30-35 sec	50-55 sec
Hose Length with Nozzle	710 mm	810mm
Operating Temperature	+5°C to +60°C	+5°C to +60°C
Height x Diameter (mm)	420x132	505x185
Cylinder Material	CRCA Steel Sheet	

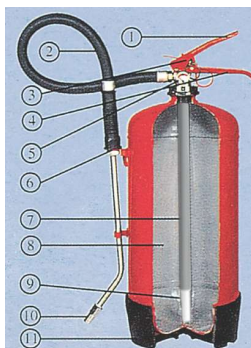

1. Valve/Extn. Lever
2. Discharge Hose
3. Safety Pin with Chain
4. Valve Handle
5. Pressure Gauge
6. Hose Holder
7. Syphon Tube
8. PVC Internal Coating
9. Filter
10. Discharge Nozzle
11. PVC Base

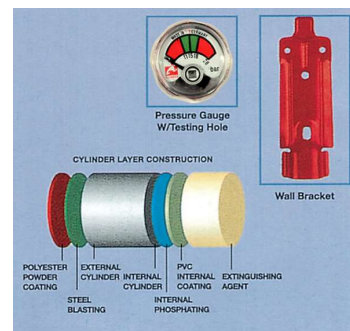

SEMI-RIGID REEL HOSE

PRODUCT DESCRIPTION

SHIELD semi-rigid reel hoses are suitable for use in fixed fire fighting system. The hoses are available in sizes of 19 mm and 25 mm inside diameter. The hoses are flexible so that it can be rolled and kept on a drum.

The hose are intended for use at a maximum working pressure of 12 bar (1.2 MPa) and temperature range of -20°C to +60°C at ambient temperature condition in non aggressive or non-corrosive atmosphere.

The semi-rigid reel hoses are manufactured to comply with BSEN 694:2014 standards.

FEATURES

- Materials for inner lining and cover of hose are plasticized PVC compound
- High tensile textile polyester yarn is used for reinforcement of hose.

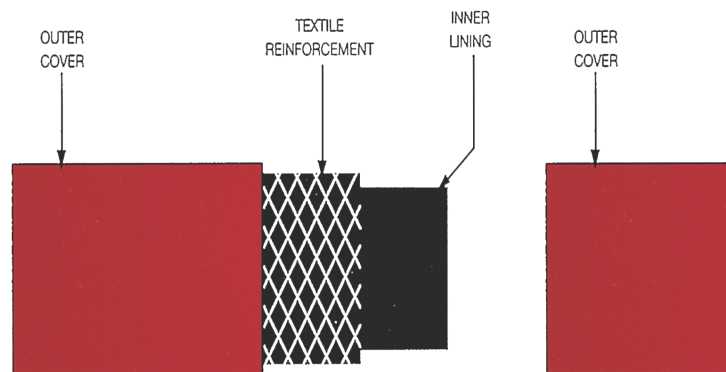

Model Number	SD-RH-19R	SD-RH-25R
Hose Classification	Type A, Class 2	
Color of Hose	Red	
Bore	19mm	25mm
Length of Hose	30m	
Hydrostatic Properties		
Maximum Working Pressure	12 Bar	
Proof Pressure	24 Bar	
Burst Pressure	42 Bar	

FIRE HOSE REEL WITH SEMI-RIGID HOSE

PRODUCT DESCRIPTION

SHIELD fire hose reels provide a very effective fire fighting facility with a continuous supply of water available immediately. The construction and performance of a fire hose reel with semi-rigid hose ensures suitable installation in buildings and other construction works for use by the occupants. The fire hose reels are manufactured in both manual and automatic versions to comply to BS EN 671-1:2012 standard with semi-rigid hose complying with BSEN 694:2014 standards.

FEATURES

- BSI Kitemark certified.
- The fire hose reels are capable of rotating in one plane (fixed type) or rotating in more than one plane with mounting on one of the following: swinging arm, swinging pipe or swinging door in manual and automatic version.
- The automatic fire hose reels will open fully within 3 revolution of the reel.
- The nozzle have SHUT, JET and SPRAY control settings.
- The minimum flow rate of hose reels in JET and SPRAY setting is 41 L/MIN. at 0.6 MPa (6 bar) pressure and setting in chrome plated rotary nozzle is 53Lpm at 0.6 Mpa (6 bar) pressure.
- The effective throw range of discharge at 0.2 MPa (2 bar) pressure is 10 mtrs. in JET setting.
- The reel discs are painted RED with printed user instructions.

OPERATING INSTRUCTIONS

AUTOMATIC HOSE REELS

- Pull out the hose and then water flow will start within 3 rotations.
- Open nozzle, adjust to spray or jet as required.
- Aim nozzle at base of fire.
- After use, close the nozzle and rewind the hose, ensuring that it is properly wound around the hose reel (not overlapping side plates). Open the nozzle to drain water from the hose and then close the nozzle on completion.

MANUAL HOSE REELS

- Open the main valve fully.
- Pull out the hose.
- Open nozzle, adjust to spray or jet as required.
- Aim nozzle at base of fire.
- After use, close the nozzle, turn off the main valve, rewind the hose, ensuring that it is properly wound around the hose reel (not overlapping the side plates). Open the nozzle to drain water from the hose and then close the nozzle on completion.



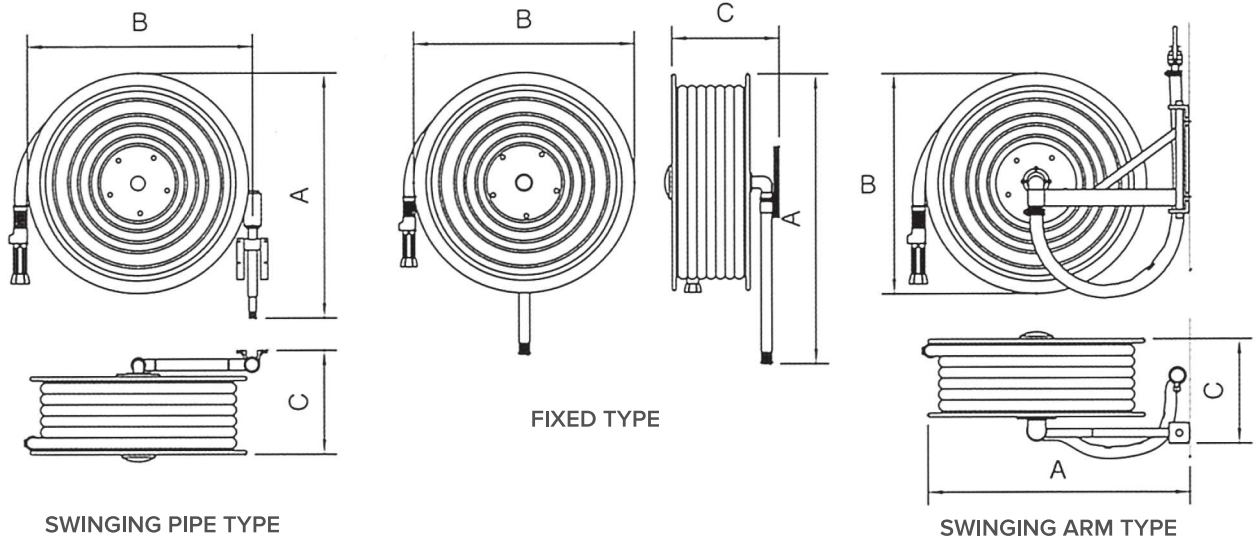

FIRE HOSE REEL ASSEMBLY

Type	Model No.	Hose Diameter & Length	Reel Height (A in mm)	Reel Width (B in mm)	Reel Depth (C in mm)
Swinging Arm <i>(Plastic Nozzle)</i>	SD19HR-SAM/SS	19mm (¾") & 30m	590	550	220
Cabinet Mounted Manual <i>(Brush / Mirror Finish)</i>	SD25HR-SAM/SS	25mm (1") & 30m	595	550	245
Swinging Arm <i>(Brass chrome plated rotary Nozzle)</i>	SD19HR-SAM/SS-B	19mm (¾") & 30m	590	550	220
Cabinet Mounted Manual <i>(Brush / Mirror Finish)</i>	SD25HR-SAM/SS-B	25mm (1") & 30m	595	550	245
Swinging Arm <i>(Plastic Nozzle)</i>	SD19HR-SAM	19mm (¾") & 30m	620	580	200
Cabinet Mounted Manual <i>(Red Painted)</i>	SD25HR-SAM	25mm (1") & 30m	625	580	245
Swinging Arm <i>(Brass Chrome Plated Rotary Nozzle)</i>	SD19HR-SAM-B	19mm (¾") & 30m	620	580	200
Cabinet Mounted Manual <i>(Red Painted)</i>	SD25HR-SAM-B	25mm (1") & 30m	625	580	245
Swinging Arm <i>(Plastic Nozzle)</i>	SD19HR-SAA/SS	19mm (¾") & 30m	590	550	220
Cabinet Mounted Automatic <i>(Brush / Mirror Finish)</i>	SD25HR-SAA/SS	25mm (1") & 30m	595	550	265
Swinging Arm <i>(Brass Chrome Plated Rotary Nozzle)</i>	SD19HR-SAA/SS-B	19mm (¾") & 30m	590	550	220
Cabinet Mounted Automatic <i>(Brush / Mirror Finish)</i>	SD25HR-SAA/SS-B	25mm (1") & 30m	595	550	265
Swinging Arm <i>(Plastic Nozzle)</i>	SD19HR-SAA	19mm (¾") & 30m	620	580	200
Cabinet Mounted Automatic <i>(Red Painted)</i>	SD25HR-SAA	25mm (1") & 30m	625	580	245

Type	Model No.	Hose Diameter & Length	Reel Height (A in mm)	Reel Width (B in mm)	Reel Depth (C in mm)
Swinging Arm <i>(Brass Chrome Plated Rotary Nozzle)</i>	SD19HR-SAA-B	19mm (¾") & 30m	620	580	200
Cabinet Mounted Automatic <i>(Red Painted)</i>	SD25HR-SAA-B	25mm (1") & 30m	625	580	245
Swinging Pipe <i>(Plastic Nozzle)</i>	SD19HR-SPM-SS	19mm (¾") & 30m	580	550	245
Wall Mounted Manual <i>(Brush / Mirror Finish)</i>	SD25HR-SPM-SS	25mm (1") & 30m	580	550	245
Swinging Pipe <i>(Brass Chrome Plated Rotary Nozzle)</i>	SD19HR-SPM/ SS-B	19mm (¾") & 30m	580	550	245
Wall Mounted Manual <i>(Brush / Mirror Finish)</i>	SD25HR-SPM/ SS-B	25mm (1") & 30m	580	550	245
Swinging Pipe <i>(Plastic Nozzle)</i>	SD19HR-SPM	19mm (¾") & 30m	595	580	220
Wall Mounted Manual <i>(Red Painted)</i>	SD25HR-SPM	25mm (1") & 30m	595	580	260
Swinging Pipe <i>(Brass Chrome Plated Rotary Nozzle)</i>	SD19HR-SPM-B	19mm (¾") & 30m	595	580	220
Wall Mounted Manual <i>(Red Painted)</i>	SD25HR-SPM-B	25mm (1") & 30m	595	580	260
Swinging Pipe <i>(Plastic Nozzle)</i>	SD19HR-SPA/SS	19mm (¾") & 30m	580	550	245
Wall Mounted Automatic <i>(Brush / Mirror Finish)</i>	SD25HR-SPA/SS	25mm (1") & 30m	580	550	285
Swinging Pipe <i>(Brass Chrome Plated Rotary Nozzle)</i>	SD19HR-SPA/ SS-B	19mm (¾") & 30m	580	550	245
Wall Mounted Automatic <i>(Brush / Mirror Finish)</i>	SD25HR-SPA/ SS-B	25mm (1") & 30m	580	550	285
Swinging Pipe <i>(Plastic Nozzle)</i>	SD19HR-SPA	19mm (¾") & 30m	595	580	220
Wall Mounted Automatic <i>(Red Painted)</i>	SD25HR-SPA	25mm (1") & 30m	595	580	260
Swinging Pipe <i>(Brass Chrome Plated Rotary Nozzle)</i>	SD19HR-SPA-B	19mm (¾") & 30m	595	580	220
Wall Mounted Automatic <i>(Red Painted)</i>	SD25HR-SPA-B	25mm (1") & 30m	595	580	260
Manual <i>(Plastic Nozzle)</i>	SD19HR-FM/SS	19mm (¾") & 30m	620	550	230
Fixed <i>(Brush / Mirror Finish)</i>	SD25HR-FM/SS	25mm (1") & 30m	620	550	275
Manual <i>(Brass Chrome Plated Rotary Nozzle)</i>	SD19HR-FM/SS-B	19mm (¾") & 30m	620	550	230
Fixed <i>(Brush / Mirror Finish)</i>	SD25HR-FM/SS-B	25mm (1") & 30m	620	550	275
Manual <i>(Plastic Nozzle)</i>	SD19HR-FM	19mm (¾") & 30m	635	580	210
Fixed <i>(Red Painted)</i>	SD25HR-FM	25mm (1") & 30m	635	580	250
Manual <i>(Brass Chrome Plated Rotary Nozzle)</i>	SD19HR-FM-B	19mm (¾") & 30m	635	580	210
Fixed <i>(Red Painted)</i>	SD25HR-FM-B	25mm (1") & 30m	635	580	250

Type	Model No.	Hose Diameter & Length	Reel Height (A in mm)	Reel Width (B in mm)	Reel Depth (C in mm)
Automatic (Plastic Nozzle)	SD19HR-FA/SS	19mm (¾") & 30m	620	550	230
Fixed (Brush / Mirror Finish)	SD25HR-FA/SS	25mm (1") & 30m	620	550	275
Automatic (Brass Chrome Plated Rotary Nozzle)	SD19HR-FA/SS-B	19mm (¾") & 30m	620	550	230
Fixed (Brush / Mirror Finish)	SD25HR-FA/SS-B	25mm (1") & 30m	620	550	275
Automatic (Plastic Nozzle)	SD19HR-FA	19mm (¾") & 30m	635	580	210
Fixed (Red Painted)	SD25HR-FA	25mm (1") & 30m	635	580	250
Automatic (Brass Chrome Plated Rotary Nozzle)	SD19HR-FA-B	19mm (¾") & 30m	635	580	210
Fixed (Red Painted)	SD25HR-FA-B	25mm (1") & 30m	635	580	250

SINGLE JACKET FIRE HOSE, TYPE 2

Single jacket fire hose consists of an impermeable elastomeric lining, a synthetic fibre reinforcement and externally applied elastomeric coating to the reinforcement. Delivery hoses are non-percolating lay flat type used in fire fighting purposes. Hoses are suitable for use with couplings with the requirements of BS 336:2010 standards. Hose is intended for use at working pressure not exceeding 15 bar. Delivery hose are manufactured to comply BS 6391: 2009 Standards.



FEATURES

- BSI Kitemark Certified.
- Light weight and flexible.
- Hose belongs to Type 2 with Elastomeric lining, Synthetic fibre reinforcement and elastomeric coating on the reinforcement.
- Hose provides good protection against the absorption of liquids and resistance of the reinforcement.
- Anti rot and anti twist.
- Hose with couplings are wound by Galvanized mild steel / SS wire.

APPLICATIONS

- Industrial and rural fire brigades as well as building protection.
- For general industrial, commercial and civil engineering applications.

HOSE DATA

Hose : Type 2
 Available Color : Red, White
 Standard Length : 25/30 Meters

SPECIFICATIONS

Model Number	Diameter (Inch.)	Working Pressure (Bar/Psi)	Burst Pressure (Bar/Psi)	Standard Compliance/Approvals
SD-DH2-65R	2.5	15/215	50/725	BS 6391: 2009/ Kitemark
SD-DH2-65W				

NH threaded. Storz & instantaneous coupling or other types are available upon request.

DELIVERY HOSE COUPLING



PRODUCT DESCRIPTION

SHIELD couplings are suitable for use with delivery hose and for fire fighting purposes. The delivery hose couplings are of instantaneous pattern, pull release type with ribbed tail and are manufactured to comply to BS 336:2010 standards. The couplings are suitable for use at working pressure not exceeding 15 bar.

FEATURES

- BSI Kitemark certified.
- Castings are clean, sound and free from gross porosity.
- Machined surface is within tolerance and is in accordance with BS 1134-2.
- Coupling washers are made of natural rubber to BS1154.
- Plungers are of self-locking type.



SDAC - 38 RT
(Aluminium Coupling)

SDAC - 65 RT
(Aluminium Coupling)

SDCC - 65 RT
(Copper Alloy Coupling)

SPECIFICATIONS

Coupling Type	Instantaneous Male / Female coupling with pull release
Tailed Ends	Ribbed tail type
Test Pressure	22.5 Bar for 1 minute

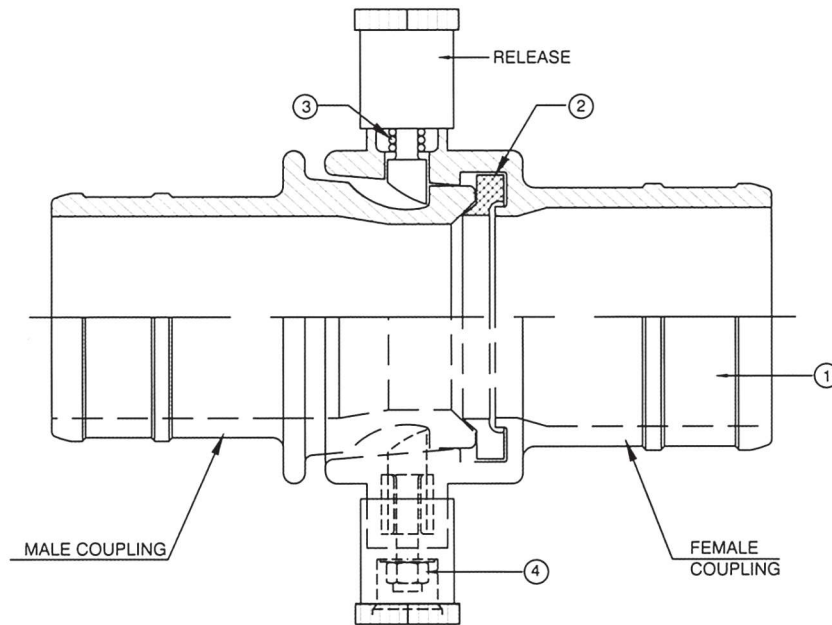

Sl. Nto.	Description	Material
1	Body Male/Female Coupling	a. Aluminium to BS EN 1706:1998 b. Copper Alloy to BS EN 12163:2011
2	Washer	Rubber
3	Spring	Spring Steel
4	Self Locking Nut	Aluminium

HANDHELD BRANCHPIPE



PRODUCT DESCRIPTION

SHIELD hand-held branch pipe is made by combination of Aluminium and plastics. The water flow control is by means of SHUT, JET and SPRAY. The branch pipe has male instantaneous coupling inlet.

FEATURES

- BSI Kitemark Certified.
- Handheld Branchpipes are manufactured in compliance with BS EN 15182-1:2007 & BS EN 15182-3:2007+ A1:2009
- Body and Tip made of Aluminium.
- Pipe material made of Polyamide.

SPECIFICATIONS

Model	SD-FB320
Type	Handheld Controllable
Flow Control	Shut, Jet & Spray
Type of Spray	Full Cone
Inlet Connection	Male instantaneous coupling to BS 336
Working Pressure	16 Bar
Hydrostatic Test Pressure	25.5 Bar
Flow Rate	240 LPM @ 6 Bar(Jet) 230 LPM @ 6 Bar(Spray)
Length	445 mm

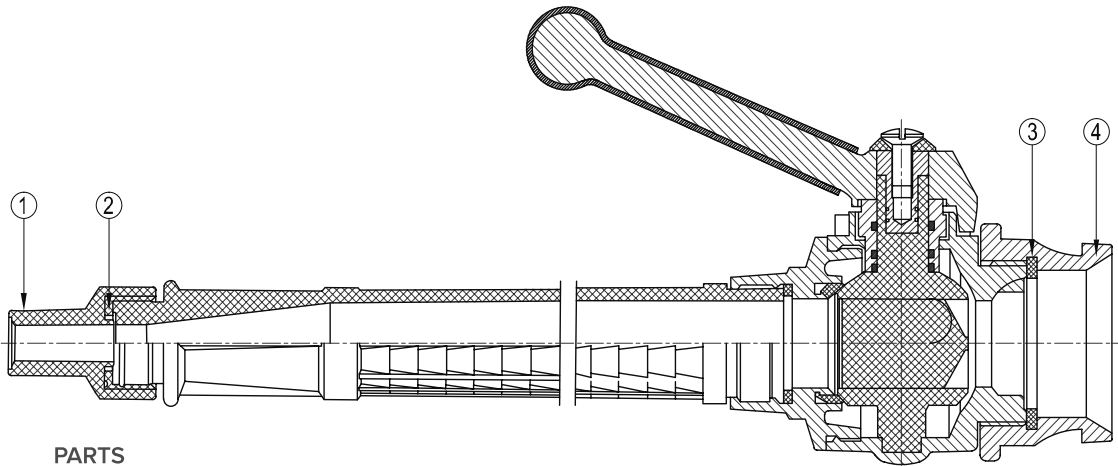

PARTS

1. Nozzle

2. Nozzle Washer

3. Inlet Coupling Washer

4. Inlet Coupling

APPLICATIONS

- Industrial and rural fire brigades as well as building protection.
- For general industrial, commercial and civil engineering applications.
- Ideal for Fire Departments and Professional Industry services.
- Refineries, Armed Forces, Airports, Ships, Oil Rigs, Heavy Industry

MAINTENANCE INSTRUCTIONS

- Keep it in cover.
- After use drain the water and disconnect from hose.
- Every 6 months verify the lever operating & Jet/ Spray

STANDARD BRANCH PIPE

PRODUCT DESCRIPTION

SHIELD standard branch pipe is made by metal, suitable to use with fire hose assembly for fire fighting purpose. The branch pipe has male instantaneous coupling inlet manufactured to comply with BS 336:2010 standards.

FEATURES

- BSI Kitemark.
- Body material made of aluminium alloy.

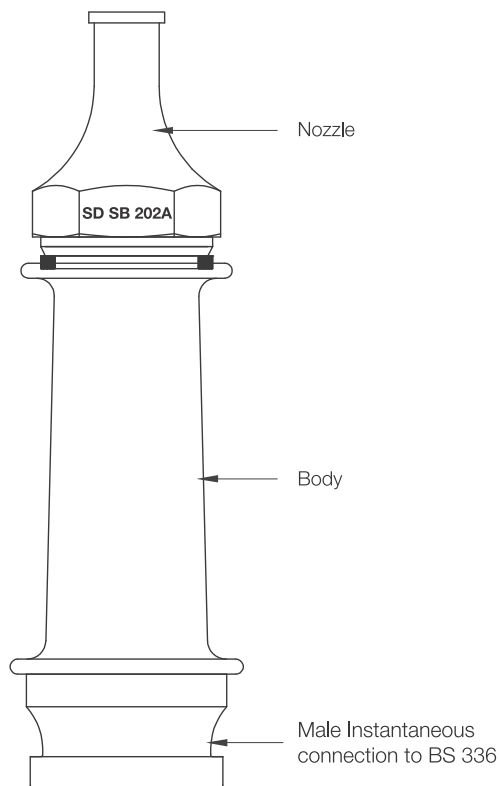

SPECIFICATIONS

Model Number	SD SB 202A
Type	Standard branch pipe
Body and Nozzle Material	Aluminium to BS EN 1706 : 2010
Inlet Connection	Male Instantaneous Coupling to BS 336:2010
Nozzle Hole Diameter	12.5mm
Working Pressure	16 Bar
Test Pressure	24 Bar

OBLIQUE LANDING VALVE, FLANGED INLET



PRODUCT DESCRIPTION

SHIELD landing valves are suitable for installation on wet risers in a building for fire fighting purposes with permanently charged water from a pressurised supply.

The landing valves are oblique type with flanged inlet and are manufactured to comply to BS 5041 Part 1 standard with delivery hose connection and blank cap complying with BS 336:2010 standard.

The landing valves are classified under low pressure and are suitable for use at nominal inlet pressure up to 15 bar.



FEATURES

- BSI Kitemark certified.
- Body material made of copper alloy to EN 1982
- Hand wheel material made of grey cast iron to BS EN 1561.
- Blank cap material made of copper alloy to EN 1982.
- Possible to replace the gland seal when under pressure with the valve fully closed.
- Disc facing rubber is of replaceable type.
- Valves are provided with a strap and pad lock so that the hand wheel can be secured to counter unauthorized use.
- The hand wheel is BLACK painted and body to RED.

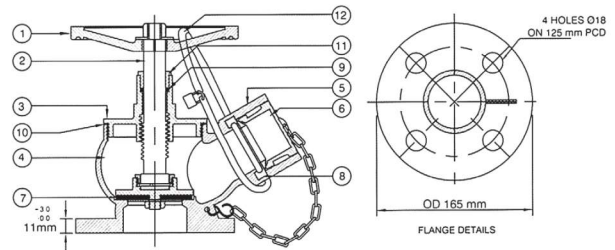

SPECIFICATIONS

Model Number	SD LVF-50
Valve Type	Oblique, Flanged Inlet
Pressure Rating	Low Pressure Valve
Nominal Size	DN50
Working Pressure	15 Bar Maximum
Test Pressure	Valve Seat Test at 16.5 Bar • Body Test at 22.5 Bar
Flange Drilling	BS 4504 Part 2:1974 Table:16/21
Water Flow Rate	8.5 L/S @ 4 Bar Outlet Pressure

BILL OF MATERIAL

Sl.No.	Description	Material
1	Handwheel	Grey Cast Iron to BS EN 1561
2	Stem	Copper Alloy to BS EN 12164
3	Bonnet	Copper Alloy to EN 1982
4	Body	Copper Alloy to EN 1982
5	Female Inst. Outlet	Copper Alloy to EN 1982
6	Blank Cap	Copper Alloy to EN 1982
7	Renewable Disk Facing	Rubber to BS 1154
8	Washer	Rubber to BS 1154
9	Gland Seal	Rubber to BS 1154
10	Bonnet Seal	Teflon
11	Gland	Copper Alloy to EN 1982
12	Strap with Pad Lock	Strap-Leather (12mm Wide, 2mm Thick) LOCK-Non-Ferrous

OBLIQUE LANDING VALVE, MALE THREADED INLET



PRODUCT DESCRIPTION

SHIELD landing valves are suitable for installation on wet risers in a building for fire fighting purposes, permanently charged with water from a pressurized supply.

The landing valves are oblique type with threaded inlet and are manufactured to comply to BS 5041 Part 1 standard with delivery hose connection and blank cap complying with BS 336:2010 standard.

The landing valves are classified under low pressure and are suitable for use at nominal inlet pressure up to 15 bar.

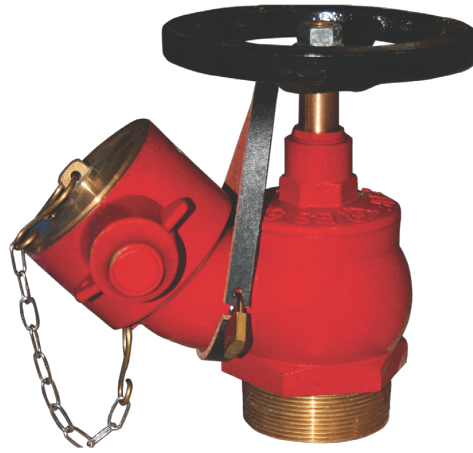
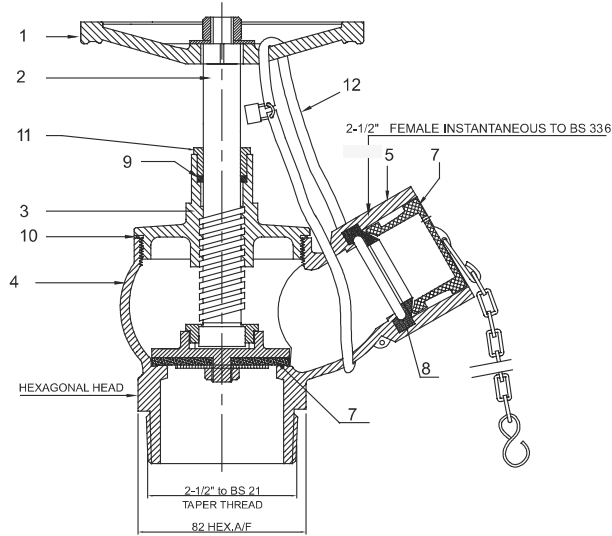

FEATURES

- BSI Kitemark approved.
- Body material made of copper alloy to EN 1982
- Hand wheel material made of grey cast iron to BS EN 1561.
- Blank cap material made of copper alloy to EN 1982.
- Possible to replace the gland seal when under pressure with the valve fully closed.
- Disc facing rubber are of replaceable type.
- Valves are provided with a strap and pad lock so that the hand wheel can be secured to counter unauthorized use.
- The hand wheel is BLACK painted and body to RED.

SPECIFICATIONS

Model Number	SD LVT-65
Valve Type	Oblique, Threaded Inlet
Pressure Rating	Low Pressure Valve
Nominal Size	DN 2½"
Working Pressure	15 Bar Maximum
Test Pressure	Valve Seat Test at 16.5 Bar • Body Test at 22.5 Bar
Water Flow Rate	8.5 L/S @ 4 Bar Outlet Pressure

BILL OF MATERIAL

Sl.No.	Description	Material
1	Handwheel	Grey Cast Iron to BS EN 1561
2	Stem	Copper Alloy to BS EN 12164
3	Bonnet	Copper Alloy to EN 1982
4	Body	Copper Alloy to EN 1982
5	Female Inst. Outlet	Copper Alloy to EN 1982
6	Blank Cap	Copper Alloy to EN 1982
7	Renewable Disk Facing	Rubber to BS 1154
8	Washer	Rubber to BS 1154
9	Gland Seal	Rubber to BS 1154
10	Bonnet Seal	Teflon
11	Gland	Copper Alloy to EN 1982
12	Strap with Pad Lock	Strap-Leather (12mm Wide, 2mm thick) LOCK-Non-Ferrous

PRESSURE REDUCING LANDING VALVE



PRODUCT DESCRIPTION

SHIELD pressure reducing oblique landing valves are suitable for installation on wet risers in buildings for fire fighting purposes, permanently charged with water from a pressurised supply.

These landing valves are pressure reducing type designed to provide a range of outlet pressure (4 bar -12 bar). The Landing valves are classified under high pressure and are suitable for use at nominal inlet pressure up to 20 bar.

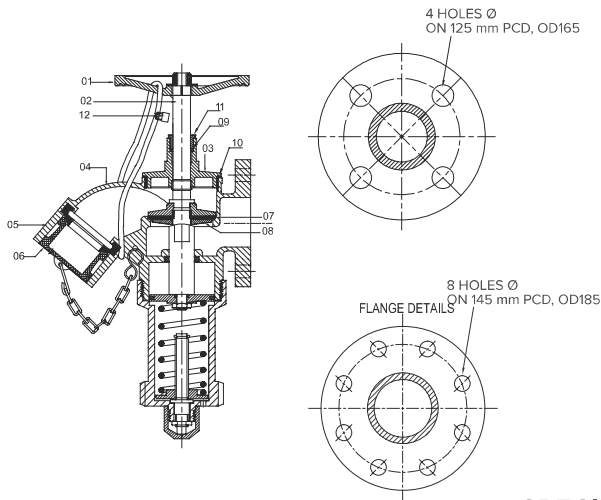

FEATURES

- BSI Kitemark approved.
- Body material made of copper alloy to EN 1982.
- Hand wheel material made of grey cast iron to BS EN 1561.
- Blank cap material made of copper alloy to EN 1982.
- Possible to replace the gland seal when under pressure with the valve fully closed.
- Disc facing rubber are of replaceable type.
- Valves are provided with a strap and pad lock so that the hand wheel can be secured to counter unauthorized use.
- The hand is painted black and the body is painted red.

SPECIFICATIONS

Model Number	SD-PRLVF-50	SD-PRLVF-65
Valve Type	Oblique, Pressure Reducing, Flanged Inlet	
Pressure Rating	High Pressure Valve	
Nominal Size	DN50	DN50
Working Pressure	20 Bar Maximum	
Test Pressure	Valve Seat Test at 22 Bar • Body Test at 30 Bar	
Flange Drilling	BS4504 Part: 2 :1974Table : 16/21	
Min. Water Flow Rate	8.5 L/S @ 4 Bar Outlet Pressure	
Min. Valve Pressure Regulating	4-12 Bar	

BILL OF MATERIAL

Sl.No.	Description	Material
1	Handwheel	Grey Cast Iron to BS EN 1561
2	Stem	Copper Alloy to BS EN 12164
3	Bonnet	Copper Alloy to EN 1982
4	Body	Copper Alloy to EN 1982
5	Female Inst. Outlet	Copper Alloy to EN 1982
6	Blank Cap	Copper Alloy to EN 1982
7	Renewable Disk Facing	Rubber to BS 1154
8	Washer	Rubber to BS 1154
9	Gland Seal	Rubber to BS 1154
10	Bonnet Seal	Teflon
11	Gland	Copper Alloy to EN 1982
12	Strap with Pad Lock	Strap-Leather (12mm Wide, 2mm Thick) LOCK-Non-Ferrous

4" X 2 WAY BREECHING INLET

PRODUCT DESCRIPTION

SHIELD breaching inlets are suitable for installation on dry risers only, in a building for fire fighting purposes, fitted with inlet connection at fire brigade access level and outlet connection at specified points, which is normally dry but capable of being charged with water by pumping from fire service appliances.

The breaching inlets are manufactured to comply with BS 5041 PART-3:1975 standard comprising of male instantaneous connections complying with BS 336:2010, drain valves complying with BS 5154, PN16 rated and non return valves.

The breaching inlets and its fittings are suitable for a normal working pressure of 10 bar.

FEATURES

- BSI Kitemark certified.
- Body material made of spheroidal graphite cast iron (Ductile Iron) to BS 1563:2011.
- Inlet connection and non-return valves material



made of copper alloy to BS 12163:2011.

- Each inlet connections are fitted with non-return valve and are of spring loaded mushroom type.
- Each breaching inlet is painted RED internally and externally.

SPECIFICATIONS

Model Number	SD-BI 2 WAY
Inlet Connection	2 Nos. Male Instantaneous Connector Complying to BS 336
Pressure Rating	Normal Working Pressure of 10 Bar
Nominal Size	100 mm Flanged Outlet
Test Pressure	20 Bar
Flange Drilling	BS 4504 Part: 2:1974 Table: 16/21

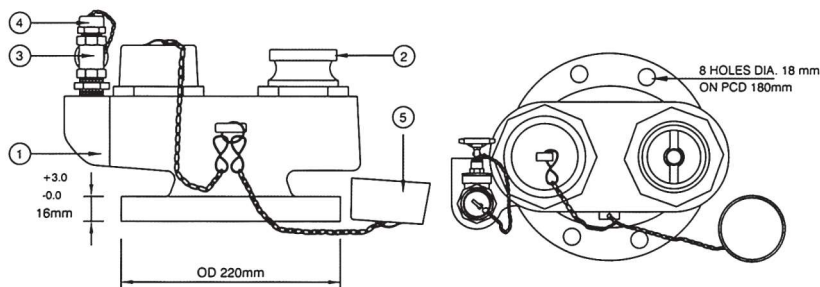

BILL OF MATERIAL

Sl.No.	Description	Material
1	Body	Spheroidal Graphite Cast Iron to BS EN 1563:2011
2	Inlet Connection & Non-Return Valves	Copper Alloy to BS EN 12163:2011
3	Drain Valve	Copper Alloy to BS EN 12163:2011
4	Blank Cap for Drain Valve	Copper Alloy to BS EN 12163:2011
5	Blank Cap for Inlet Connector	Plastic

6" X 4 WAY BREECHING INLET

PRODUCT DESCRIPTION

SHIELD breaching inlets are suitable for installation on dry risers only, in a building for fire fighting purposes, fitted with inlet connection at fire brigade access level and outlet connection at specified points, which is normally dry but capable of being charged with water by pumping from fire service appliances.

The breaching inlets are manufactured to comply with BS 5041 PART-3:1975 standard comprising of male instantaneous connections complying with BS 336:2010, drain valves complying with BS 5154, PN16 rated and non-return valves.

The breaching inlets and its fittings are suitable for a normal working pressure of 10 bar.

FEATURES

- BSI Kitemark certified.
- Body material made of spheroidal graphite cast iron (Ductile Iron) to BS 1563:2011.
- Inlet connection and non-return valves material made of copper alloy to BS 12163:2011.
- Each inlet connection is fitted with non-return valve and of spring loaded mushroom type.
- Each breaching inlet is painted RED internally and externally.



SPECIFICATIONS

Model Number	SD-BI 4 WAY
Inlet Connection	4 Nos. Male Instantaneous Connector Complying to BS 336
Pressure Rating	Normal Working Pressure of 10 Bar
Nominal Size	150 mm Flanged Outlet
Test Pressure	20 Bar
Flange Drilling	BS 4504 Part : 2 : 1974 Table : 16/21

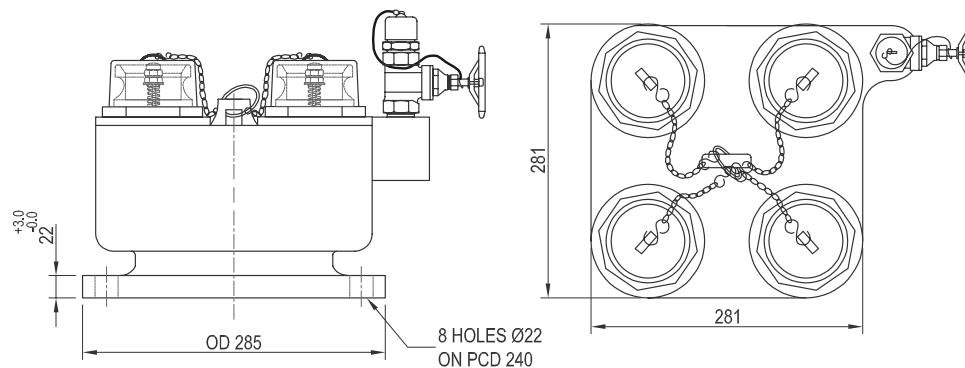

BILL OF MATERIAL

Sl.No.	Description	Material
1	Body	Spheroidal Graphite Cast Iron to BS EN 1563:2011
2	Inlet Connection & Non-Return Valves	Copper Alloy to BS EN 12163:2011
3	Drain Valve	Copper Alloy to BS EN 12163: 2011
4	Blank Cap for Drain Valve	Copper Alloy to BS EN 12163: 2011
5	Blank Cap for Inlet Connector	Plastic

DRY PILLAR FIRE HYDRANTS



FEATURES

- BSI-KITEMARK approved
- SHIELD Fire Hydrants are manufactured to comply BS EN 14384: 2005, BS 1074-1, BS 1074-2 & BS 1074-6 Standards.
- Dry barrel design eliminates damage to the hydrant caused by freezing of the upper part.
- SHIELD Fire Hydrants are designed for high performance and easy to install, maintain and repair.
- Excellent and proven flow characteristics.
- 2 x 2½" gate valve with female instantaneous outlet to BS 336:2010.
- Body material made of spheroidal graphite cast iron (Ductile Iron) to BS 1563:2011.
- 2 x 2½" Female Instantaneous quick coupling adaptor to BS 336:2010, flanged inlet to BS EN 1092-2
- 1 x 4" Male/Female BSRT pumper to BS 336:2010.
- Aluminum Hood / GRP cover is provided for protection and misusing.
- Operation threads are corrosion protected and for easy operation.
- SHIELD Fire Hydrants are high Pressure rating to 16 Bar.
- Drain starts automatically when hydrant is closed.
- Internal epoxy paint system gives high corrosion protection to hydrants.
- Hydrant protective covers with handle for easy handling.

DESIGN SPECIFICATIONS

SHELL MATERIAL

Spheroidal graphite cast iron. (Ductile Iron)

OBTURATOR

- The design of obturator (base valve) in hydrant is made in such way that it can be replaced at site.
- Material of base valve is high tensile brass.

RESISTANCE TO DISFUNCTION PRODUCTS

Hydrant is built to withstand misuse that may cause dysfunctional failures.

INLET FLANGED TO BS EN 1092-2

CORROSION PROTECTION

All ferrous components liable to corrode are prepared and coated as detail below:

SURFACE PREPARATION:

Each hydrant is shot blasted (inside & outside)

PAINT SYSTEM

- **INSIDE:** Barrel inside and rod coated with 3 coat epoxy paint system, 200 microns DFT.
- **OUTSIDE:** Outside coating top portion primer coating and red polyurethane coating, 200 microns. Bottom portion outside two coat black bituminous coating, 200 microns.

FIELD OF APPLICATION

- Fire fighting purpose.
- Suitable for non-potable water supply purpose only.

GENERAL DIMENSIONAL DETAILS

SL.No.	Model No.	Inlet Flange Size in inch (DN)	Dimensions in mm		Working Pressure
			A	B	
SDHC Series					
1	100 SDHC-800	4 (100)	1515	530	16
2	100 SDHC-1200	4 (100)	1915	530	16
SDFHV Series					
1	100 SDFHV-800	4 (100)	1450	430	16
2	100 SDFHV-1200	4 (100)	1850	430	16
3	150 SDFHV-800	6 (150)	1500	480	16
4	150 SDFHV-1200	6 (150)	1900	480	16
SDFHQ Series					
1	100 SDFHQ-800	4 (100)	1450	430	16
2	100 SDFHQ-1200	4 (100)	1850	430	16
3	150 SDFHQ-800	6 (150)	1500	480	16
4	150 SDFHQ-1200	6 (150)	1900	480	16
SDFHQC Series					
1	100 SDFHQC-800	4 (100)	1450	430	16
2	100 SDFHQC-1200	4 (100)	1850	430	16
3	150 SDFHQC-800	6 (150)	1500	480	16
4	150 SDFHQC-1200	6 (150)	1900	480	16
SDFHQS-CD Series					
1	100 SDHQS-CD 800	4 (100)	1450	430	16
2	100 SDHQS-CD 1200	4 (100)	1850	430	16
3	150 SDHQS-CD 800	6 (150)	1500	480	16
4	150 SDHQS-CD 1200	6 (150)	1900	480	16
SDFHQM Series					
1	150 SDFHQM-800	6 (150)	1500	480	16
2	150 SDFHQM-1200	6 (150)	1900	480	16

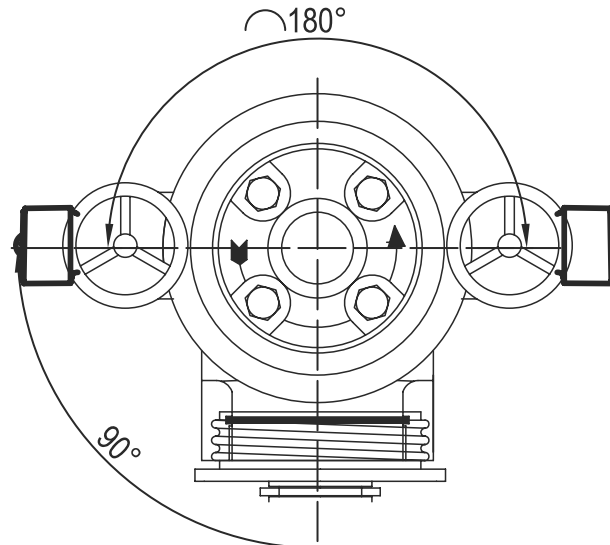

SDHC

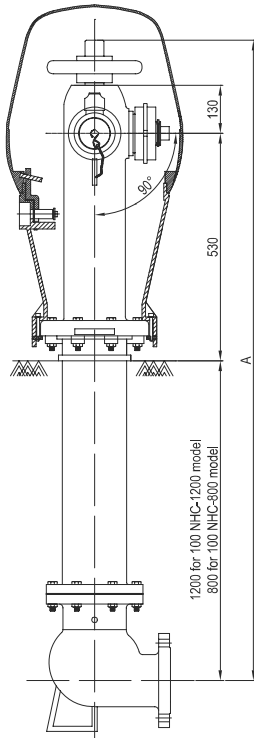

SDHV

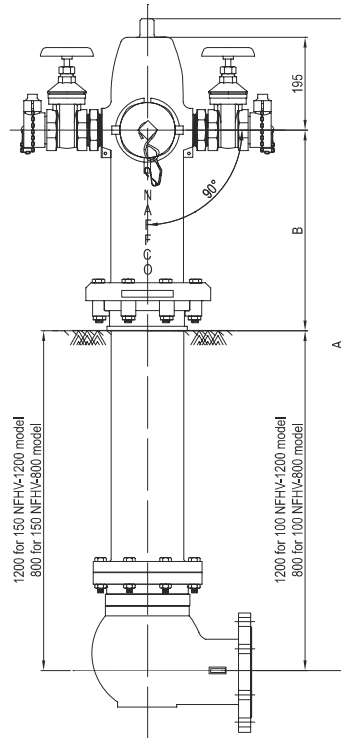

SDHQ

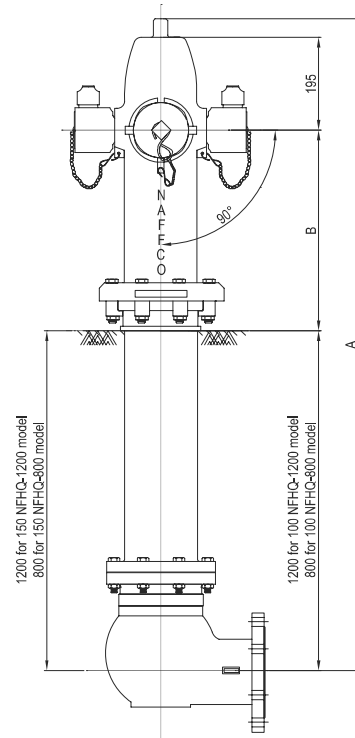

SDHQC

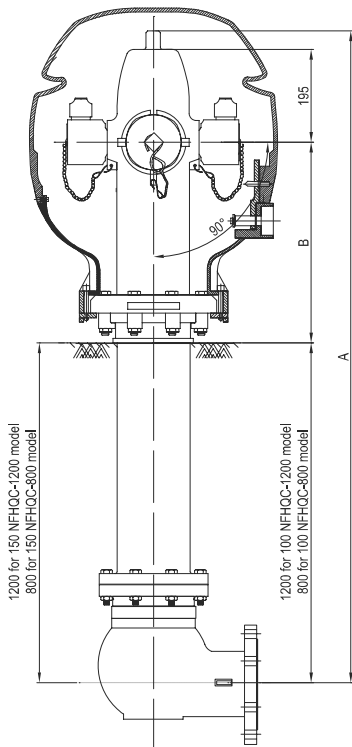

SDHQS-CD

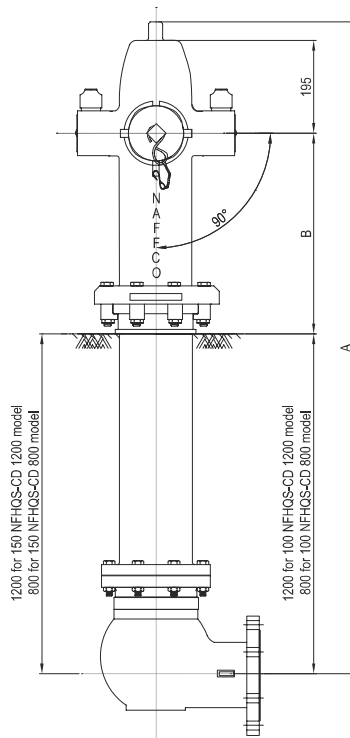

SDHQM

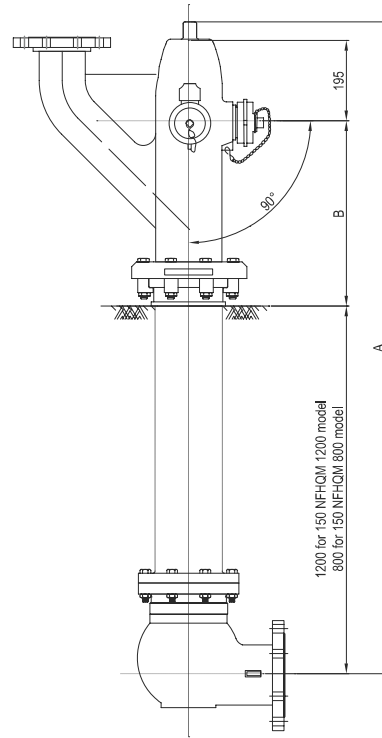

UNDER GROUND HYDRANT



PRODUCT DESCRIPTION

SHIELD under ground fire hydrants are valves of screw down type and are suitable for a maximum working pressure of 16 bar.

The underground fire hydrants are manufactured to comply to BS 750:2012 and EN 14339:2005 standards with screwed outlet threaded to BS 336:2010 standard.

FEATURES

- BSI Kitemark certified.
- Body material made of grey cast iron to BS 1503-3.
- Material of spindle and threaded part of valves which engages with it is made of stainless steel to BS 10088-1.
- Material for the screwed outlet is made of high tensile brass to BS 12163:2011.
- Spindle sealings (two seals) is of the toroidal sealing ring ('O' ring) type and are capable of changing while the valve is under pressure and fully closed.
- A wiper ring is positioned above the spindle sealings to prevent the ingress of foreign matter.
- Each hydrant shot is blasted (inside and outside) to SA 2 ½ std.
- All cast iron parts are thoroughly cleaned and painted.



Model Number	SDHYD058	
Valve Type	Screw down (type 2C)	
Nominal Size & Flange Drilling	Flange-X Flange-Y Flange-Z	PN16, DN80, BS EN 1092-2 PN16, DN80, BS EN 1092-2 PN16, DN80, BS EN 1092-3
Working Pressure	16 Bar maximum	
Test Pressure (Body)	Body	25 Bar
	Seat	20 Bar
Flange Drilling	BS 4504 Part : 2 : 1974 Table : 16/21	

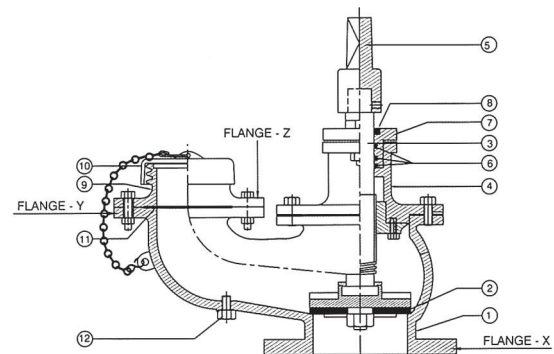

BILL OF MATERIAL

Sl.No.	Description	Material
1	Body	Grey Cast Iron(C.I) to BS 1503-3
2	Body Seating Seal	Rubber to BS 1154
3	Spindle	Stainless steel to BS EN 10088-1
4	Bonnet	Grey Cast Iron(C.I) to EN 1503-3
5	Spindle Cap	Grey Cast Iron to EN 1503-3
6	Spindle (Stem) Seal	Rubber to BS 1154
7	Gland	Grey Cast Iron to EN 1503-3
8	Gland Wiper Ring	Teflon
9	Outlet	High Tensile Brass to BS 12163:2011
10	Outlet Cap	Grey Cast Iron to EN 1503-3
11	Outlet Gasket	Rubber to BS 1154
12	Drain Bolt	Forged Steel

STAND PIPE OUTLET (SINGLE & DOUBLE)

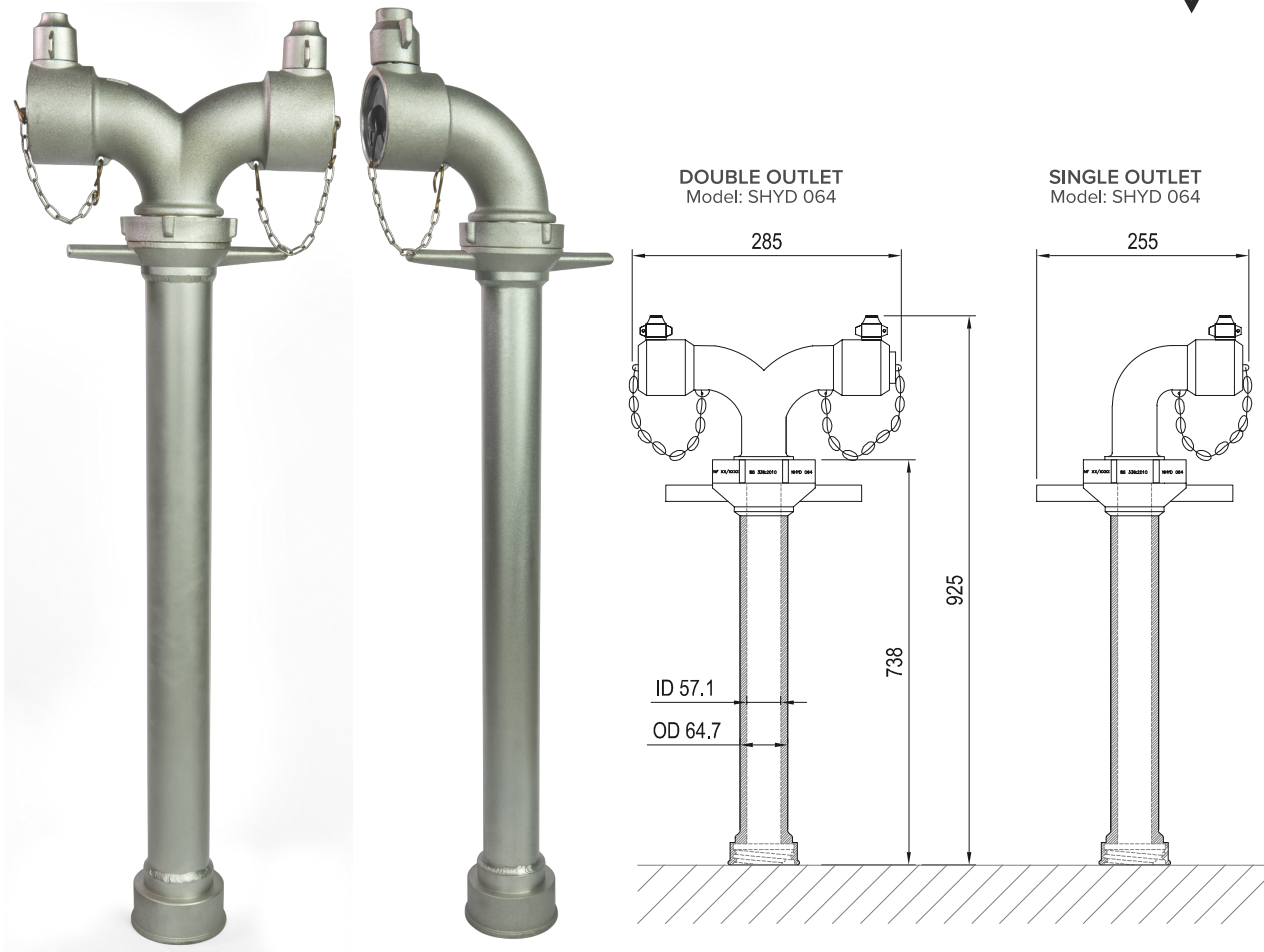

PRODUCT DESCRIPTION

NAFFCO Standpipes are suitable for installation on underground hydrants for firefighting purpose changed with water from a pressurized supply.

These standpipes are designed and manufactured to comply BS336:2010 Standard with screwed inlet threaded and comprising of male instantaneous connections.

FEATURES

- BSI Kitemark approved
- Body material made of Aluminum Alloy
- Standpipes are designed with swivel upper end so that at the outlets can be rotated 360° for operation

BILL OF MATERIAL

BILL OF MATERIAL		
Model Number	SDHYD-62	SDHYD-64
Type	Single Outlet	Double Outlet
Material	Aluminium Alloy	
Inlet Connection	3" female BSRT to BS336	
Outlet Connection	1 x 2 1/2" female instantaneous coupling to BS 336	2 x 2 1/2" female instantaneous coupling to BS336
Test Pressure	24 BAR for 2 minutes	





SHIELD FIRE, SAFETY & SECURITY LTD

Redburn House, 2A Tonbridge Road, Romford, Essex - RM3QE, United Kingdom
Tel: +44 1708 377731, Fax: +44 1708 347637, E-mail: Shielduk@shieldglobal.com
www.shieldglobal.com