

HANDHELD BRANCHPIPE



PRODUCT DESCRIPTION

SHIELD hand-held branch pipe is made by combination of Aluminium and plastics. The water flow control is by means of SHUT, JET and SPRAY. The branch pipe has male instantaneous coupling inlet.

FEATURES

- BSI Kitemark Certified.
- Handheld Branchpipes are manufactured in compliance with BS EN 15182-1:2007 & BS EN 15182-3:2007+ A1:2009
- Body and Tip made of Aluminium.
- Pipe material made of Polyamide.

SPECIFICATIONS

Model	SD-FB320
Type	Handheld Controllable
Flow Control	Shut, Jet & Spray
Type of Spray	Full Cone
Inlet Connection	Male instantaneous coupling to BS 336
Working Pressure	16 Bar
Hydrostatic Test Pressure	25.5 Bar
Flow Rate	240 LPM @ 6 Bar(Jet) 230 LPM @ 6 Bar(Spray)
Length	445 mm

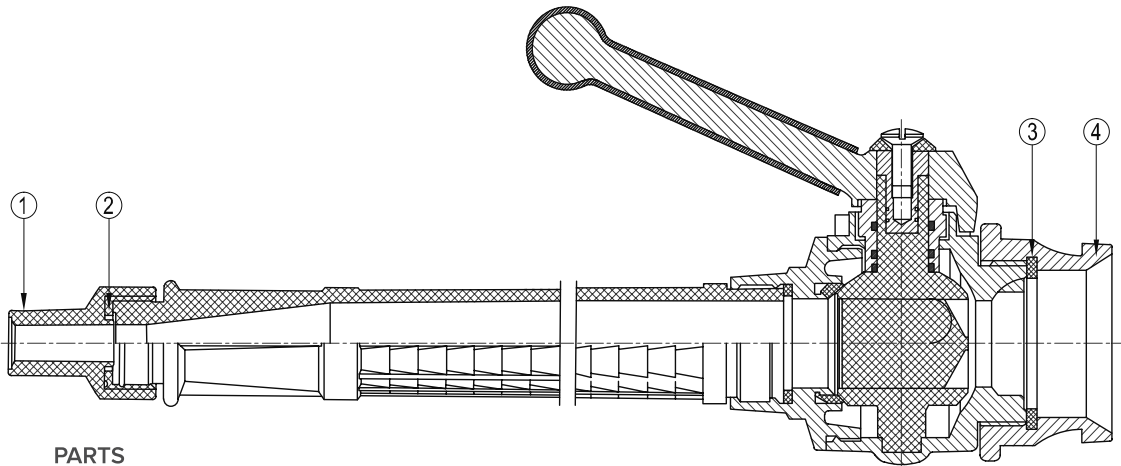

PARTS

1. Nozzle

2. Nozzle Washer

3. Inlet Coupling Washer

4. Inlet Coupling

APPLICATIONS

- Industrial and rural fire brigades as well as building protection.
- For general industrial, commercial and civil engineering applications.
- Ideal for Fire Departments and Professional Industry services.
- Refineries, Armed Forces, Airports, Ships, Oil Rigs, Heavy Industry

MAINTENANCE INSTRUCTIONS

- Keep it in cover.
- After use drain the water and disconnect from hose.
- Every 6 months verify the lever operating & Jet/ Spray