



FIRE RATED GLAZED DOOR

Fire rated glazed doors and frames incorporate precise European engineering to provide a sleek, modern alter-native to traditional steel hollow metal frames. The Glazed door system possesses narrow / wide stile or hollow metal wide stile steel profiles, thereby exceeding traditional fire-rated frame systems in aesthetics and performance. Available, with fire ratings from 20 to 240 minutes, this system can incorporate a wide range of fire-rated glazing materials with glass sizes that surpass traditional systems.

AREAS OF APPLICATION

- Schools and Libraries
- Hospitals
- Shopping Malls
- Government Buildings
- Office Entrances and Corporate Locations
- Airports
- Metros and Rail Terminals

KEY FEATURES

- Full Vision Fire Doors
- Available in Narrow / Wide Steel Profiles and Hollow Metal Wide Stile Construction
- Modular system that can incorporate up to 240* Minutes Fire Integrity
- Powder Coated at factory to match desired color scheme
- Optionally, Brushed Stainless Steel finish available
- Tested to UBC 7-2, UBC 7-4, ANSI/UL 9, 10B, 10C [Positive Pressure Test Standard] (or) BS 476 Part 22 Standard
- Oversize options available
- Multiple Glazing Options [Firelite, Firelite NT, Firelite Plus and Pyrostop], Contraflam
- Easy Installation similar to typical storefront systems
- Frames supplied Welded or Knock-Down, ready for Installation
- Hardware available to fit functional requirements (Please check with Shield for compatibility)

LISTINGS

Classified and labeled by Underwriters Laboratories Inc.® and Underwriters Laboratories of Canada. File number for labeled 20/45/60/90 minute fire-rated frame assemblies is R39060. Frame tests performed in accordance with UL 9 and NFPA 257. Door tests performed in accordance with UL 10B, UL 10C, NFPA 80 and NFPA 252.

FRAMING		
RATING	MAX. EXPOSED GLASS AREA PER PIECE	MAX. EXPOSED GLASS DIMENSION
20 min.	6,272 in ² (4.05 m ²)	106-1/2 in (2.71 m)
45 min.	4,500 in ² (2.90 m ²)	95-1/4 in (2.42 m)
60 min.	5,616 in ² (3.62 m ²)	96 in (2.44 m)
90 min.	2,627 in ² (1.69 m ²)	56-1/2 in (1.44 m)

DOORS		
RATING	MAX. SINGLE DOOR LEAF SIZE	MAX. EXPOSED GLASS SIZE PER PIECE
20 min.	42 X 96 in (1.07 m X 2.43m)	36 x 89 in (.91 m x 2.26 m)
45 min.	42 X 96 in (1.07 m X 2.43m)	36 x 89 in (.91 m x 2.26 m)
60 min.	42 X 96 in (1.07 m X 2.43m)	36 x 89 in (.91 m x 2.26 m)
90 min.	43 x 95-7/8 in (1.09m x 2.44m)	36 x 56-1/2 (divided lite door) in (.91 m x 1.44 m)

STANDARD HARDWARE MAY INCLUDE:

- Hinges
- Surface mounted closers
- Single mortise lock
- Panic hardware
- Handle
- Bottom Seal

Size Selection Chart for assemblies tested to BS 476 Standards

Description	Fire Integrity in Minutes	Max. Width in mm	Max. Height in mm	Max. Area in sqm
Single Acting Swinging Doors				
Max. Door Leaf Size	180	1159	2304	-
Max. DLO Glass	180	871	2064	-
Max. Door Leaf Size	240	1008	2208	-
Max. DLO Glass	240	720	1968	-

Note: 'DLO' in the above table refers to Day Light Opening; The above mentioned DLO are indicative and is subject to glazing type.





Heat Barrier Series

FIRE-RATED DOORS & FRAMES FOR 60/90/120 MINUTE APPLICATIONS

Fireframes Heat Barrier Series doors and frames provide a barrier to radiant and conductive heat transfer. Incorporating precise European engineering, the system also allows full-lite fire doors for aesthetic or security reasons. Heat Barrier Series doors (with ratings up to 90 minutes) and frames (with ratings up to 2 hours) are classified and labeled with UL and ULC.

FEATURES

- Narrow steel profiles
- Doors available in single leaf or double leaf design
- Modular system that can incorporate 60/90 minute full-lite temperature rise doors
- Can incorporate large individual panes of Fireglass glass
- Passes positive pressure test standards UL 10C
- Frames supplied "K-D" (or welded upon request)
- Unrestricted glazing area for use in locations where total glazing exceeds 25% of wall area
- Durable steel frames ensure low maintenance system
- Hardware available to fit functional requirements.
- Finish painted at the factory to match desired color scheme
- Easy installation similar to typical storefront systems
- Brushed stainless steel finish available (doors only)

LISTINGS

Classified and labeled by Underwriters Laboratories, Inc.® Underwriters Laboratories of Canada. Frame tests performed in accordance with UL 263 / ASTM E-119 (60-120 minutes), CAN/ULC-S101, NFPA 251, UL 9, UL 10C. Fireframes Designer Series and Fireframes Heat Barrier Series doors tested in accordance UL 10B, UL 10C, and NFPA 252.

FRAMING		
RATING	MAX. EXPOSED GLASS AREA PER PIECE	MAX. EXPOSED GLASS DIMENSION
45 min.	7,442 in ² (4.80 m ²)	118-1/8 in (3.00 m)
60 min.	3,724 in ² (2.40 m ²)	96 in (2.44 m)
90 min.	3,730 in ² (2.41 m ²)	111 in (2.81 m)

DOORS		
RATING	MAX. SINGLE DOOR LEAF SIZE	MAX. EXPOSED GLASS SIZE PER PIECE
60 min.	42" X 96" (1.07 m X 2.44m)	36" x 89" (.91 m x 2.26 m)
90 min.	43" x 95" - 7/8" (1.09m x 2.44m)	36" x 56" - 1/2" (divided lite door) (.91 m x 1.44 m)

Note: Individual lite sizes cannot exceed "Max. Exposed Glass Area" shown above.



DOOR DETAILS

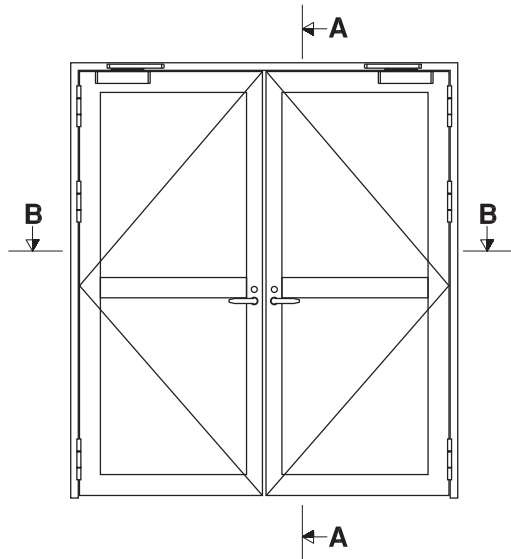

A-A

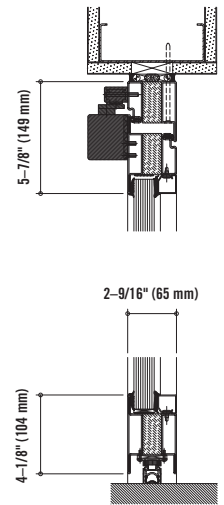

B-B

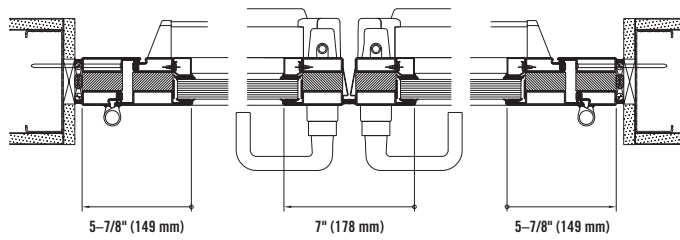

A-A

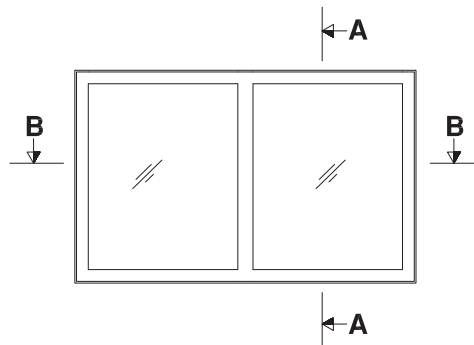
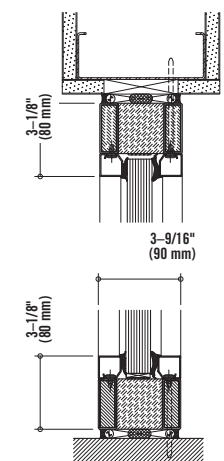

B-B

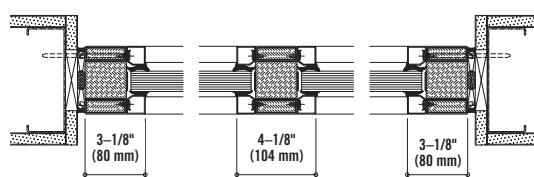

STANDARD HARDWARE MAY INCLUDE:

- Hinges
- Surface mounted closers
- Single mortise lock
- Panic hardware
- Handle
- Bottom Seals