

# Shield - Hydraulic & Electric Release Trim Deluge Valve 200 NB

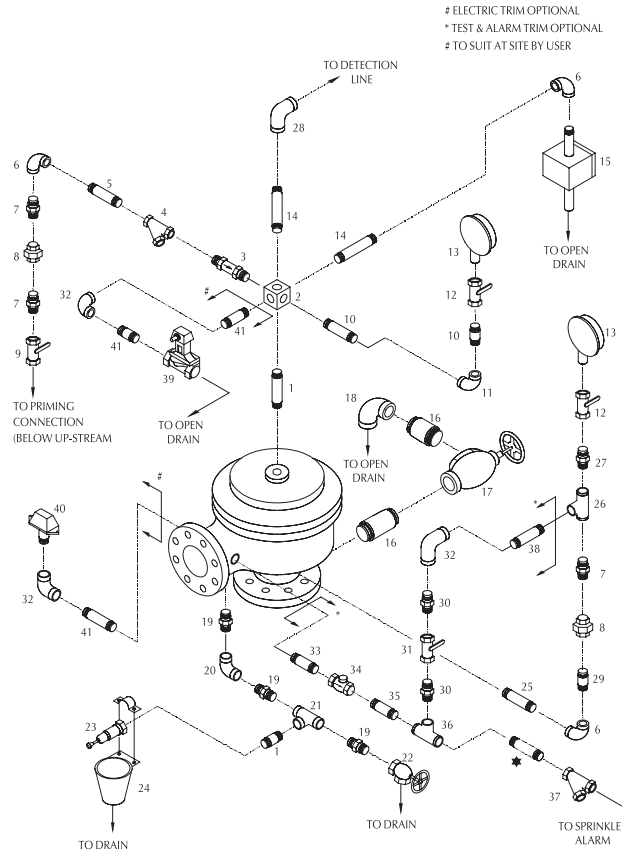

## PART LIST

ITEM NO.	CODE	DESCRIPTION	QTY.	SIZE
1	9396	PIPE NIPPLE	2	1/2" X 85 mm LG
2	6251	6 WAY MANIFOLD	1	'SHIELD' MAKE MODEL - SD-A
3	1906	RESTRICTION CHECK VALVE	1	'SHIELD' MAKE MODEL - SD-A
4	9381	'Y' TYPE STRAINER	1	1/2"
5	9465	PIPE NIPPLE	1	1/2" X 165 mm LG
6	9376	ELBOW	3	1/2"
7	9365	HEX NIPPLE	3	1/2"
8	9370	UNION	2	1/2"
9	9423	BALL VALVE	1	1/2"
10	9395	PIPE NIPPLE	2	1/4" X 110 mm LG
11	9374	ELBOW	1	1/4"
12	9477	GAUGE VALVE	2	1/4"
13	9456	PRESSURE GAUGE	2	1/4", 0 to 2050 kPa, 3 1/2" dial.
14	9405	PIPE NIPPLE	1	1/2" X 330 mm LG
15	1916	EMERGENCY RELEASE STATION	1	'SHIELD' MAKE MODEL - SD-A
16	9409	PIPE NIPPLE	2	2" X 130 mm LG
17	9394	ANGLE VALVE	1	2"
18	9380	ELBOW	1	2"
19	9367	HEX NIPPLE	3	1"
20	9378	ELBOW	1	1"
21	9412	REDUCING TEE	1	1" X 1/2" X 1"
22	9391	ANGLE VALVE	1	1"

ITEM NO.	CODE	DESCRIPTION	QTY.	SIZE
<b>OPTIONAL</b>				
23	1911	DRIP VALVE	1	'SHIELD' MAKE MODEL - SD-A
24	1901	FUNNEL	1	'SHIELD' MAKE MODEL - SD-A
25	9402	PIPE NIPPLE	1	1/2" X 185 mm LG
26	9410	TEE	1	1/2"
27	9413	REDUCING HEX NIPPLE	1	1/2" X 1/4"
28	9418	REDUCING ELBOW	1	1" X 1/2"
29	9465	PIPE NIPPLE	1	1/2" X 190 mm LG
30	9365	HEX NIPPLE	2	1/2"
31	9423	BALL VALVE	1	1/2"
32	9376	ELBOW	3	1/2"
33	9406	PIPE NIPPLE	1	3/4" X 100 mm LG
34	9415	NON RETURN VALVE	1	3/4"
35	9426	PIPE NIPPLE	1	3/4" X 60 mm LG
36	9411	REDUCING TEE	1	3/4" X 1/2" X 3/4"
37	9382	'Y' TYPE STRAINER	1	3/4"
38	9403	PIPE NIPPLE	1	3/4" X 210 mm LG
39	-	SOLENOID VALVE	1	1/2" SIZE 24V DC/ 110V AC/220V AC
40	-	PRESSURE SWITCH	1	1/2"
41	9400	PIPE NIPPLE	3	1/2" X 135 mm LG



# Shield - Pneumatic & Electric Release Trim Deluge Valve 200 NB

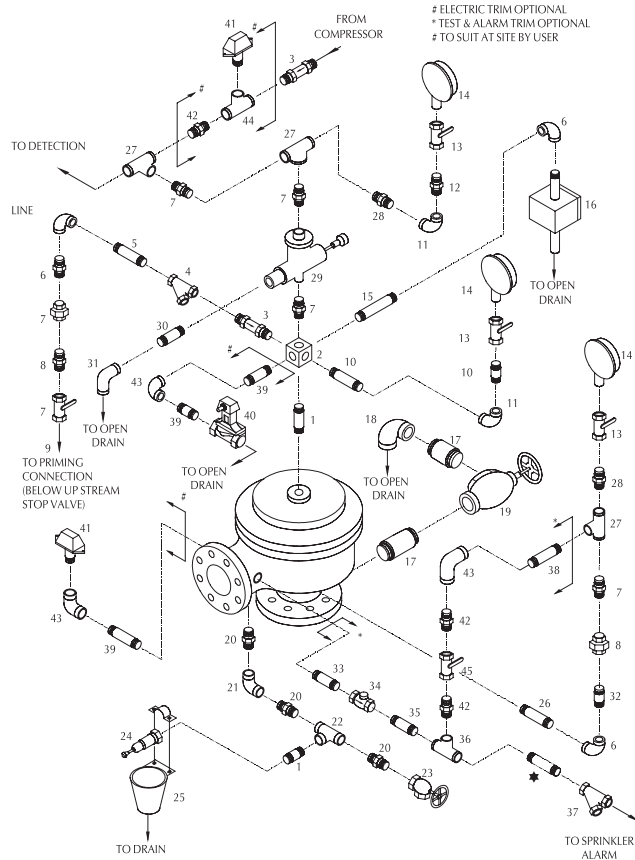

## PART LIST

ITEM NO.	CODE	DESCRIPTION	QTY.	SIZE
1	9396	PIPE NIPPLE	2	1/2" X 85 mm LG
2	6251	6 WAY MANIFOLD	1	'SHIELD' MAKE MODEL - SD-A
3	1906	RESTRICTION CHECK VALVE	2	'SHIELD' MAKE MODEL - SD-A
4	9381	'Y' TYPE STRAINER	1	1/2"
5	9465	PIPE NIPPLE	1	1/2" X 165 mm LG
6	9376	ELBOW	3	1/2"
7	9365	HEX NIPPLE	6	1/2"
8	9370	UNION	2	1/2"
9	9423	BALL VALVE	1	1/2"
10	9395	PIPE NIPPLE	2	1/4" X 110 mm LG
11	9374	ELBOW	2	1/4"
12	9363	HEX NIPPLE	1	1/4"
13	9477	GAUGE VALVE	3	1/4"
14	9456	PRESSURE GAUGE	3	1/4", 0 to 2050 kPa, 3 1/2" dial.
15	9405	PIPE NIPPLE	1	1/2" X 330 mm LG
16	1916	EMERGENCY RELEASE STATION	1	'SHIELD' MAKE MODEL - SD-A
17	9409	PIPE NIPPLE	2	2" X 130 mm LG
18	9380	ELBOW	1	2"
19	9394	ANGLE VALVE	1	2"
20	9367	HEX NIPPLE	3	1"
21	9378	ELBOW	1	1"
22	9412	REDUCING TEE	1	1" X 1/2" X 1"
23	9391	ANGLE VALVE	1	1"

ITEM NO.	CODE	DESCRIPTION	QTY.	SIZE
<b>OPTIONAL</b>				
24	1911	DRIP VALVE	1	'SHIELD' MAKE MODEL - SD-A
25	1901	FUNNEL	1	'SHIELD' MAKE MODEL - SD-A
26	9402	PIPE NIPPLE	1	1/2" X 185 mm LG
27	9410	TEE	3	1/2"
28	9413	REDUCING HEX NIPPLE	2	1/4" X 1/2"
29	1436	POSITIVE DRAIN ACTUATOR	1	'SHIELD' MAKE MODEL - SD-A
30	9407	PIPE NIPPLE	1	3/4" X 130 mm LG
31	9377	ELBOW	1	3/4"
32	9465	PIPE NIPPLE	1	1/2" X 190 mm LG
33	9406	PIPE NIPPLE	1	3/4" X 100 mm LG
34	9415	NON RETURN VALVE	1	3/4"
35	9426	PIPE NIPPLE	1	3/4" X 60 mm LG
36	9411	REDUCING TEE	1	3/4" X 1/2" X 3/4"
37	9382	'Y' TYPE STRAINER	1	3/4"
38	9403	PIPE NIPPLE	1	1/2" X 210 mm LG
39	9400	PIPE NIPPLE	3	1/2" X 135 mm LG
40	-	SOLENOID VALVE	1	1/2" SIZE 24V DC / 110V AC / 220V AC
41	-	PRESSURE SWITCH	2	1/2"
42	9365	HEX NIPPLE	3	1/2"
43	9376	ELBOW	3	1/2"
44	9410	TEE	1	1/2"
45	9423	BALL VALVE	1	1/2"

